



TEFC - ALUMINUM



HP: 1 - 30

Frame: 143T - 280T

RPM: 3600/1800/1200

Pole: 2/4/6

3Φ Volt: 208 - 230/460V

Encl: (TEFC) IP 55



Standard Features :

- NEMA Premium Efficiency
- Dual Voltage - Three Phase 230/460V
- 3600/1800/1200 RPM - 2/4/6 Pole
- Inverter Duty -15:1 Constant Torque (MG1 Part 31)
- Totally Enclosed Fan Cooled IP 55 Protection
- VPI Lap wound Stator with Anti-fungal Coating
- Double Lip Oil Seal on DE & ODE
- Internal Shaft Grounding Brush
- 1.25 SF - 143T and Up
- 50 Hz Capable at 1.0 SF
- 40° C Ambient Temperature Rating
- 1045 Carbon Steel Shaft
- Multi-mount Frame with Removable Feet
- Oversized Drive End Bearing
- One-Way Brass Condensation Drains
- Aluminum Conduit Box 90° Rotatable
- Class F Insulation System with Class H Stator
- F1, F2, F3 Box Position Convertible (Shipped F1)
- Class 1, Division 2, Group C & D Compliant
- Installation up to 3300 ft Altitude
- 36 Month Warranty from Purchase Date

HP	Sync Speed	Model Number	List Price	
			Rigid Base	C - Face
1	3600	GX3-AL-TF-143T-2-B-D-1	430	483
	1800	GX3-AL-TF-143T-4-B-D-1	430	483
	1200	GX3-AL-TF-145T-6-B-D-1	499	538
1.5	3600	GX3-AL-TF-143T-2-B-D-1.5	453	506
	1800	GX3-AL-TF-145T-4-B-D-1.5	468	521
	1200	GX3-AL-TF-182T-6-B-D-1.5	682	762
2	3600	GX3-AL-TF-145T-2-B-D-2	502	555
	1800	GX3-AL-TF-145T-4-B-D-2	501	554
	1200	GX3-AL-TF-184T-6-B-D-2	785	850
3	3600	GX3-AL-TF-182T-2-B-D-3	684	770
	1800	GX3-AL-TF-182T-4-B-D-3	671	758
	1200	GX3-AL-TF-213T-6-B-D-3	991	1,086
5	3600	GX3-AL-TF-184T-2-B-D-5	750	834
	1800	GX3-AL-TF-184T-4-B-D-5	757	842
	1200	GX3-AL-TF-215T-6-B-D-5	1,293	1,373
7.5	3600	GX3-AL-TF-213T-2-B-D-7.5	1,023	1,159
	1800	GX3-AL-TF-213T-4-B-D-7.5	1,068	1,173
10	3600	GX3-AL-TF-215T-2-B-D-10	1,173	1,309
	1800	GX3-AL-TF-215T-4-B-D-10	1,221	1,361
15	3600	GX3-AL-TF-215T-2-B-D-15	1,791	1,862



TEFC - ALUMINUM COMPONENTS



Model #	Description	List Price
PRF140-2	143/5T Replacement Fan	\$25
PRF180-2	182/4T Replacement Fan	\$41
PRF210-2	213/5T Replacement Fan	\$57



Model #	Description	List Price
CFK140T	143/5T C-Face Aluminum Conv Kit	\$44
CFK180T	182/4T C-Face Aluminum Conv Kit	\$85
CFK210T	213/5T C-Face Aluminum Conv Kit	\$110



Model #	Description	List Price
ROS140	143/5T Oil Seal	\$7
ROS180	182/4T Oil Seal	\$7
ROS210	213/5T Oil Seal	\$7



Model #	Description	List Price
SFC140	143/5T Steel Fan Cover	\$10
SFC180	182/4T Steel Fan Cover	\$16
SFC210	213/5T Steel Fan Cover	\$19



Model #	Description	List Price
ARF140-J	140T Aluminum Replacement Feet	\$13
ARF180-J	180T Aluminum Replacement Feet	\$19
ARF210-J	210T Aluminum Replacement Feet	\$28



Model #	Description	List Price
AB140-GX	143/5T Frame Conduit Box	\$25
AB180	182/4T Frame Conduit Box	\$44
AB210	213/5T Frame Conduit Box	\$44

MOTOR MODIFICATIONS

Mod. Model # + Frame Adder	Description	Frame Sizes(List Price)				
		143T	182T	213T		
		145T	184T	215T		
MODFGADT	C-Face Adaption + Kit	\$384	\$384	\$384		
MODTB	Terminal Blocks (6 Post)	\$111	\$127	\$175		
MODF2F3	F-1 to F-2 Conversion	\$384	\$384	\$384		
MODTFCAO	TEFC to TEAO Conversion	\$349	\$349	\$349		
MODCT	TEFC to TEAO Cooling Tower	\$590	\$617	\$644		

Mod. Model # + Frame Adder	Description	Frame Sizes(List Price)				
		143T	182T	213T		
		145T	184T	215T		
MODSH	Space Heaters	\$482	\$482	\$482	40W	40W
MODWTS	Winding Thermostats	\$541	\$541	\$541		
MODCOAT	Repainting motor(Epoxy or Poly)	\$381	\$408	\$435		
	Frame Adder:	143/5	182/4	213/5		

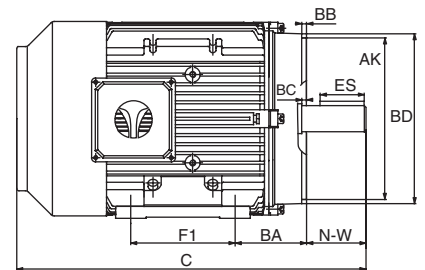
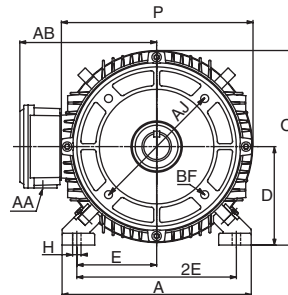
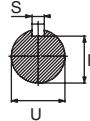
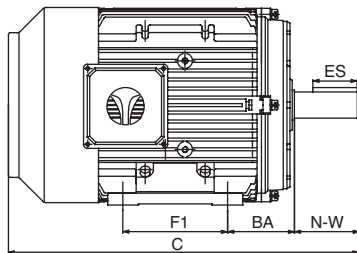
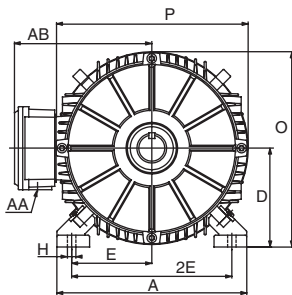

Frame	A	AA	AB	AJ	AK	BA	BB	BC	BD	BF	C	D	E	ES	2E	F1	H	O	P	R	S	U	N-W
143T	6.9	3/4	5.65	---	---	2.25	---	---	---	---	13.7	3.5	2.75	1.41	5.5	4	0.5 x 0.34	7	6.9	0.771	0.188	0.875	2.25
143TC				5.875	4.5	0.16	0.125	---	4 x 3/8														
145T				---	---	---	---	---	---														
145TC				5.875	4.5	0.16	0.125	---	4 x 3/8														
182T	8.85	3/4	6.6	---	---	2.75	---	---	---	---	16.1	4.5	3.75	1.78	7.5	4.5	0.59 x 0.43	8.85	8.6	0.986	0.25	1.125	2.75
182TC				7.25	8.5	0.25	0.19	8.95	4 x 1/2-13														
184T				---	---	---	---	---	---														
184TC				7.25	8.5	0.25	0.19	8.95	4 x 1/2-13														
213T	10.3	1.0	7.4	---	---	3.5	---	---	---	---	19	5.25	4.25	2.41	8.5	5.5	---	10.4	10.2	1.201	0.312	1.375	3.38
213TC				7.25	8.5	0.25	0.25	8.95	4 x 1/2-13														
215T				---	---	---	---	---	---														
215TC				7.25	8.5	0.25	0.25	8.95	4 x 1/2-13														